

Modell 2200

D Bauteile

GB Construction elements

F éléments de construction

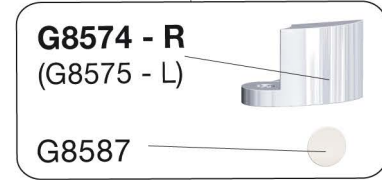
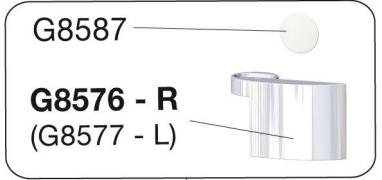
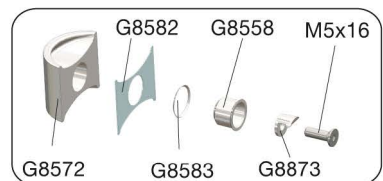
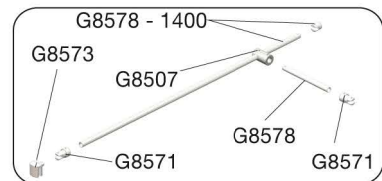

L = Linksanschlag
left hand mounting
charnière à gauche

R = Rechtsanschlag
right hand mounting
charnière à droite

GEO® Duschwände
Spiegelschränke
Acryl- Tassen u. Wannen
... auf Dauer besser

Modell 2200

Achtung! Gläser niemals ungeschützt auf den Boden stellen.
Verletzung der Glaskante führt zu Glasbruch.
Caution! Never put glass walls on the floor without protection.
Damaging the glass edges results in breaking of the glass.
Attention! Jamais plaquer des parois de douche en verre au sol sans protection. Des verres endommagés casseront.

GEO® Duschwände
Spiegelschränke
Acryl- Tassen u. Wannen
... auf Dauer besser

Zum Aufbau benötigen Sie
for mounting you need
pour l'installation il vous faut



Modell 2200 komplett März 2104/tsk



Mitgeliefertes Montagematerial
supplied assembly material
matériaux pour assemblage

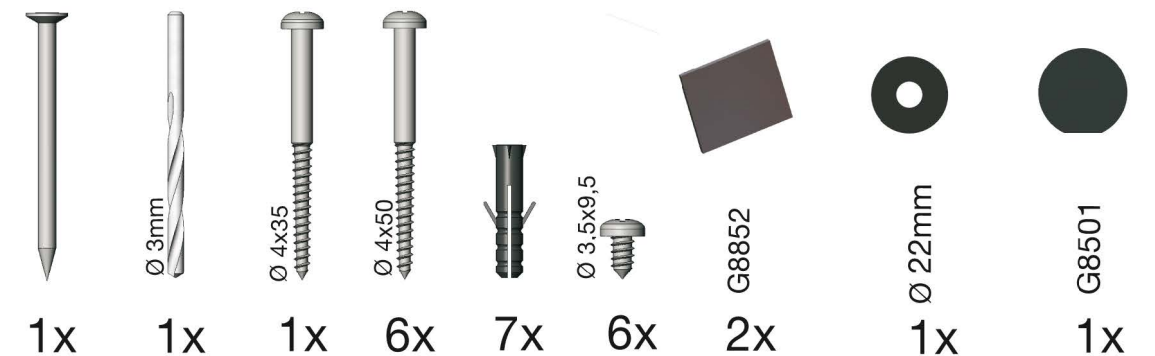

GEO Produkte GmbH • Friedrichsfelder Straße 27 • 68723 Schwetzingen/Germany
Telefon +49 (0)6202 2093-0 • Fax +49 (0)6202 2093-99 • www.geoprodukte.com • info@geoprodukte.com
Technische Hotline: +49 (0)6202 2093-42 • Mo-Fr 7:00h - 20:00h • Samstag 9:00h - 15:00h

1

Montageanleitung für Rechtsanschlag (Linksanschlag = spiegelbildlich)
 assembly instructions for right hand mounting (left hand mounting = mirror inverted)
 instruction d'assemblage pour charnière à droite (à gauche = inversé latéralement)

Modell	Duschassen-Einbaumaß Shower tray / installation dimension Dimensions de montage bacs de douche (mm)	Bodengleicher Einbau Ground level installation Pose au sol d1 (mm)
800	785-805	755-775
900	885-905	855-875
1000	985-1005	955-975

Technical drawing showing dimensions: 36, 22, 16,5, 25, 8,5, 6, 30. A warning icon indicates a 4 x 50 drill bit is used.

2

Diagrams showing the adjustment of the door using G8623 and G8627 components. A 45-degree angle is indicated for the G8623 adjustment.

3

Diagrams H, J, K, L, M, A, B, C, D, I, G, F, E showing the final assembly and leveling of the door. A level is used to ensure the door is level (A=B). Dimensions include ca. 200 mm, 15 mm, 45 mm, 33 mm, 110 mm, min. 12 mm, min. 50 mm, Ø 3 mm, 3,5 x 9,5.

4

Diagrams A, B, C showing the final sealing of the door. A cross-section diagram shows the application of silicone (Silikon) to the bottom of the door. A 24h curing time is indicated. A 'Stop' and 'Klick!' (click) sound are noted.